

ROHRE - geschweißt
PIPES - welded

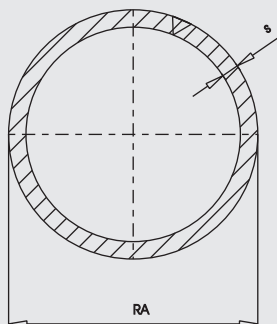

Material: EUCARO® 10 CuNi10Fe1,6Mn

Standards: DIN 86018

in nominal	RA mm OD	s mm	Gewicht weight kg / m	s mm	Gewicht weight kg / m	s mm	Gewicht weight kg / m	s mm	Gewicht weight kg / m	s mm	Gewicht weight kg / m	s mm	Gewicht weight kg / m
12	324	4,0	35,77	4,5	40,24	5,0	44,71						
14	368	4,0	40,69	4,5	45,78	5,0	50,86						
16	419	4,0	46,39	4,5	52,12	5,0	57,91						
18	457	4,0	50,60	4,5	56,90	5,0	63,20						
20	508					5,0	70,30						
24	610					5,0	84,50						
28	711							6,0	118,2				
32	813							6,0	135,3				
36	914									8,0	202,0		
40	1016									8,0	225,4		
48	1220									8,0	271,0		
56	1420									8,0	315,7		
64	1620											10,0	450,0